

Technical Data Sheet



The United States of America:
by Peter Kwasny Inc.
62-64 Enter Lane
Islandia, NY 11749

Distributed in

Canada:
Peter Kwasny Spraypaint Canada Inc.
40 University Avenue, Suite 904
Toronto, ON. M5J 1T1

Toll free North America
Phone: 1-844-426-6330 / Fax: 1-866-226-6434
order@kwasny.us / service@kwasny.us
www.spraymax.com

SprayMax® **2K 2in1 Headlight Clear** **Art. Nr. 3684068**



Product

Description / Purpose

SprayMax® Special 2K Clear Coat is a protective coating for polycarbonate lenses suitable for fixing scratches, yellowness or foggy headlights. Cristal clear, easy to apply comes in a 250 ml size. Resistance to environmental and for day to day use. Increases protection against UV light, salt water, car wash, etc. increases night visibility.

Properties

- Special product for the preparation of headlights coated with clear lacquer
- Provides durable UV and weathering resistance
- Protection against physical damages (Stonechips)

Material base

Two-component acrylic resins
Activator: aliphatic isocyanates

Gloss level

gloss

Solid content

92 gloss units at 20° measuring angle
approx. 58 % by weight relating to the diluted paint

EPA Coating Category

CCP Clear Coatings Product
PWR Limit 1.50



**CARB Aerosol Rule Coating Category
(01/2017)**

TCC Two Component Coating
PWR Limit 1.20

Substrate

Surface preparation:

Step by step Pre-treatment of the Headlights

1. Clean surface with Soap and Water and dry surface.
2. Spray and wipe dry with SprayMax Wax & Grease Remover 3680094
3. Mask area around the headlights.

Note: avoid any over spray on vehicle

Sanding of Headlights.

4. Sand manually or with a mechanical sander, sand the surface of the lens with the least aggressive sandpaper (dry or wet) working towards a P 1000.

IMPORTANT NOTE:

Clean and dry between sandpaper grit changes using SprayMax Wax & Grease Remover and dry.

5. Final sanding of the lens, manual or mechanical with P 3000 wet.

Final Preparation of lens prior to the 2K Clearcoat 3684068 application.

6. Clean and dry lens using SprayMax Wax & Grease Remover 3680094.
7. First Application of Clear Coat: Apply a thin even coat of 2K 2in1 Clear 3684068. Allow a flash time of 10 min at 68° F / 20° C and apply a medium wet coat for film build and finish.

Note: Use in a well ventilated area

Processing

Protection measures



Wear personal protection equipment.
(respiratory mask / gloves / goggles)

For more information, see safety data sheet.

Shake

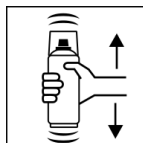

Before activating, shake can thoroughly for 2 minutes from when the mixing balls are heard.

Place red button

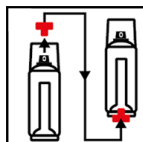

Remove the red button from the cap. Turn the can by 180° and fit the button onto the pin.

Press red button

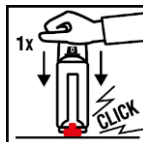

Turn the can upside down and place on a firm surface. Press the red button with the palm of your hand until it clicks into place.

Shake

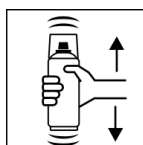

After activating, shake can again thoroughly for 2 minutes, again from when the mixing balls are heard.

Spray to test

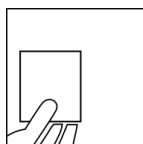

After shaking the can, test spray and check compatibility with the surface and the colour.

Spraying distance

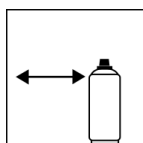

6 - 8 inches / 15 - 20 cm

Spray passes

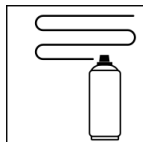

Dry film thickness 1.6 mil (40 µm)
(approx. 2 spray coats)
Apply a thin even coat of 2K 2in1 Clear 3684068.
Allow a flash time of 10 min at 68°F/20°C and apply a medium wet coat for film build and finish.

Flash-off time

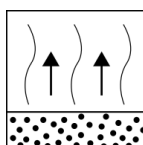

Flash time: approx. 10 min between each spray coat

Processing conditions

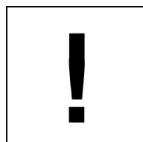

Optimum application at 64° F - 77° F (18° C - 25° C)
and a relative humidity from 40 - 60 %.

Drying

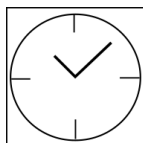

dust dry: 15 - 20 min
dry to touch: 3 h
Ready for polishing: over night
The stated values refer to the above mentioned processing conditions. The level of dryness is determined pursuant to DIN 53150.



IR- drying possible,
Observe equipment description
10 min end flash off; after
25 - 30 min at 140° F / 60° C object temperature

Continue

Can be polished over night at room temperature
or 30 min at 140° F / 60° C

Pot life

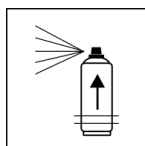

Approx. 8 h at at 68° F (20° C) room temperature
and a relative humidity of approx. 40 - 50 %.
The processing time depends on the ambient
temperature. Higher temperatures reduce the pot
life, lower temperatures will prolong it.

Finish

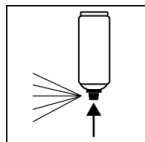

After painting, turn the can upside down and spray
for 3 - 5 seconds to clean the valve.

Additional Information

Important Information



Avoid bumps, friction and impact.

Shelf Life

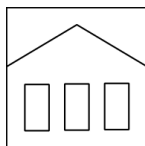

36 months (not activated)
The usage period refers to an unused can that is
stored correctly at a temperature of 68° F / 20° C
and a relative humidity below 60%. The can must be
stored and transported in an upright position in a dry
place where it is protected against chemical and
mechanical influences. The safety information on the
can and all statutory provisions applicable for the
storage site must be observed.

Disposal



The completely emptied spray cans must be dis-
posed of in the recycling system. Cans with hardened
material must be disposed of as special waste.

**Note**

For professional use only.

Identification, see safety data sheet.

The contents in this technical data sheet were created with great care and reflect our current state of knowledge. They provide the user with application-specific information and do not promise certain properties. The information is non-binding and we accept no liability for its integrity, accuracy and completeness. They do not relieve the user of their duty to check the suitability of our product for the intended purpose. The warnings printed on our labels must be respected. Our brands and patents are protected by copyright. All rights reserved. We reserve the right to update, amend or supplement the content of the information without prior notice.